

# 19386

PO# 6707

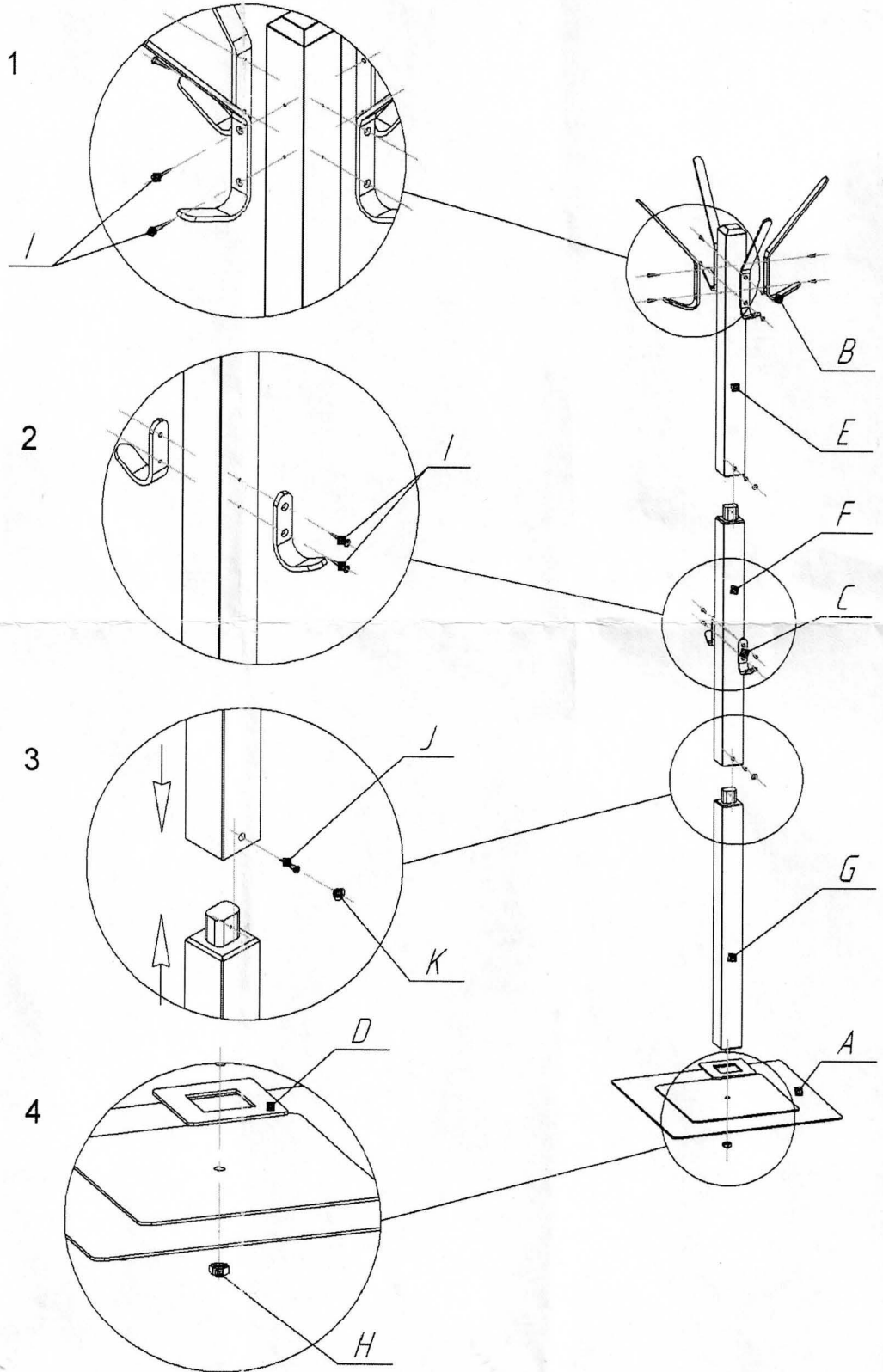
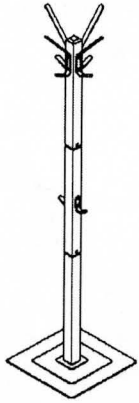

Ax1 pcs		
Bx4 pcs	Cx2 pcs	Dx1 pcs
Ex1 pcs	Fx1 pcs	Gx1 pcs
Hx1 pcs	Ix12 pcs	Jx2 pcs
M10	3,5x19	3,5x25
Kx2 pcs		
(φ8)		